



T5, Crook o' Lune Caton Road, Lancaster, LA2 9HP

A stunning two bedroom holiday home located in the idyllic surroundings of the Crook O' Lune near Lancaster. The perfect home from home, the property can sleep up to six, with a large living and dining area made for entertaining. The sleeping space comprises of two well proportioned bedrooms, with ample storage in the form of wardrobes and overhead cupboards adding to the sleek modern feel of the interior. Each room benefits from double glazed windows that give the property a light and airy feel.

Located on one of the largest plots on the site, the property boasts a private seating area to the rear, and manicured lawns all around, making it a great summer getaway location. There is the option to add extra entertaining space with decking if you require. For the colder months, a feature fireplace in the living room and luxurious carpets in the bedrooms creates a warm and inviting space to shelter in.

Located in the Crook O' Lune, an area of renowned natural beauty, there is easy access to the surrounding countryside. A cycle track follows the River Lune into Lancaster City Centre, or it is a short distance to the nearby towns of Caton and Halton, great for if you need to visit the local shops, or for a well deserved pub lunch.



Exterior

Surrounded by well kept lawns with a private seating area to the rear of the property with privacy from neighbours.

Living Room

15'5" x 12'7" (4.71 x 3.85)

Spacious living room with large windows to the front and a feature fireplace. Ample room for sofas and a dining table. Sofa pulls out into a double bed.

Kitchen

12'7" x 8'0" (3.85 x 2.46)

Kitchen features an integrated oven, four ring gas hob and a double sink and drainer beneath a double glazed window.

Bathroom

8'5" x 4'4" (2.58 x 1.34)

Modern bathroom with a full size shower bath, low flush WC, sink unit and double glazed window.

Main Bedroom

12'7" x 10'1" (3.85 x 3.09)

Main bedroom fits a double bed and has plenty of storage in the form of built in wardrobes and overhead cupboards. Includes two bed side lights and a double glazed window.

Bedroom 2

8'0" x 5'6" (2.45 x 1.68)

Second bedroom fits two single beds, with overhead storage, a built in wardrobe and a double glazed window.





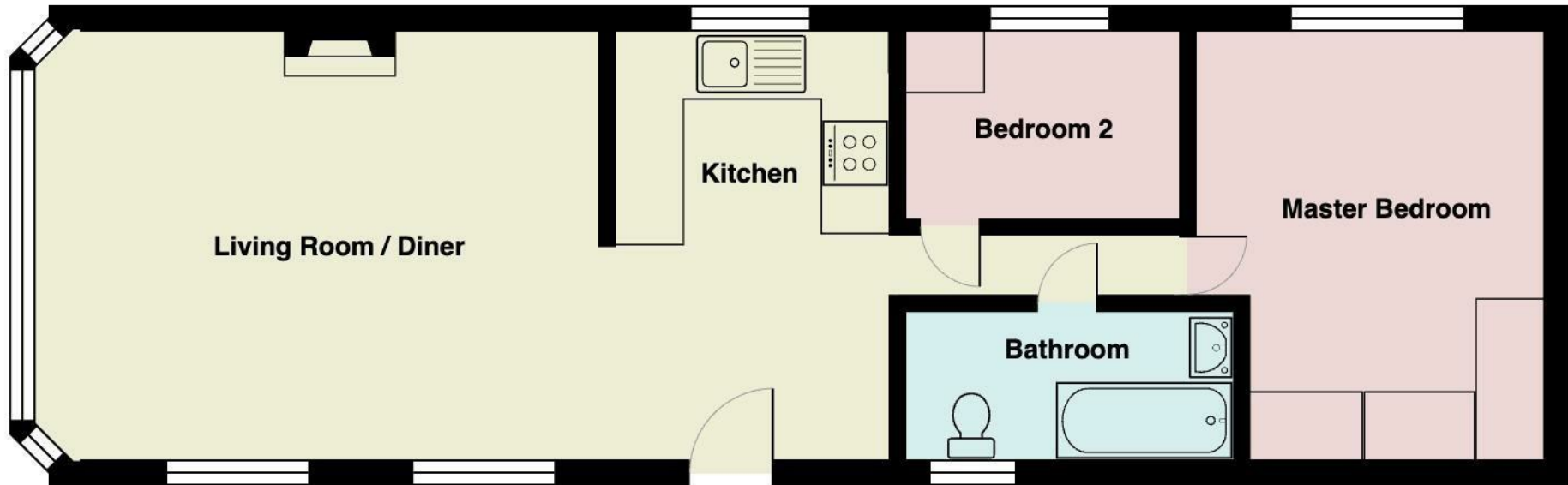

Your Award Winning Houseclub

